

# XuP-Steri A



XuP-Steri A is dedicated to air disinfection and purification. Thanks to the combination of photocatalysis and UV-C disinfection, the mobile robot destroys pathogens, such as Volatile Organic Compounds (VOCs), viruses, bacteria, odors, etc. This solution limits the spread of infectious diseases in indoor environments.

**138 m<sup>3</sup>**

Volume of air treated/h

**8 hours**

Run Time

**1.80 m/s**

Max speed

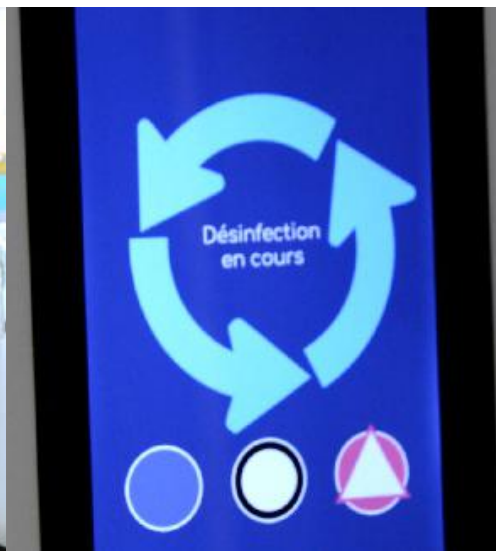

## Disinfection column

Limits the risk of airborne contamination, with a 99% destruction rate of micro-organisms.

## Eco-friendly

The robot does not release any by-products harmful to health and the environment, so it can be used continuously with vulnerable populations.

## Safe

Designed according to a risk analysis following the Machinery Directive 2006/42/EC and the standard ISO 3691-4.

## Options



Visual Warning presence system



Acuity localization

# A turnkey solution

## Automatic disinfection

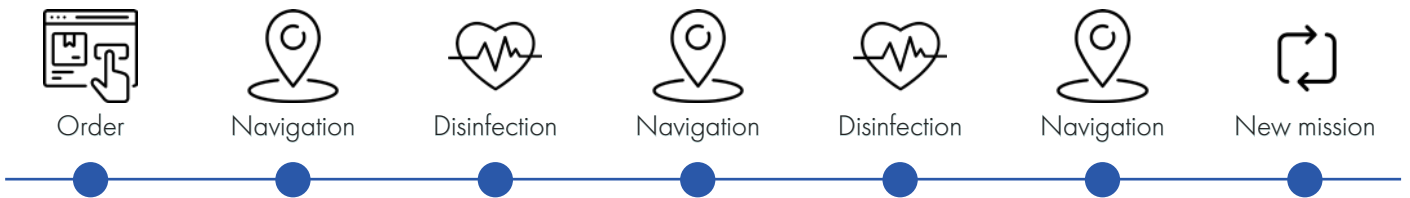

## Solution ecosystem

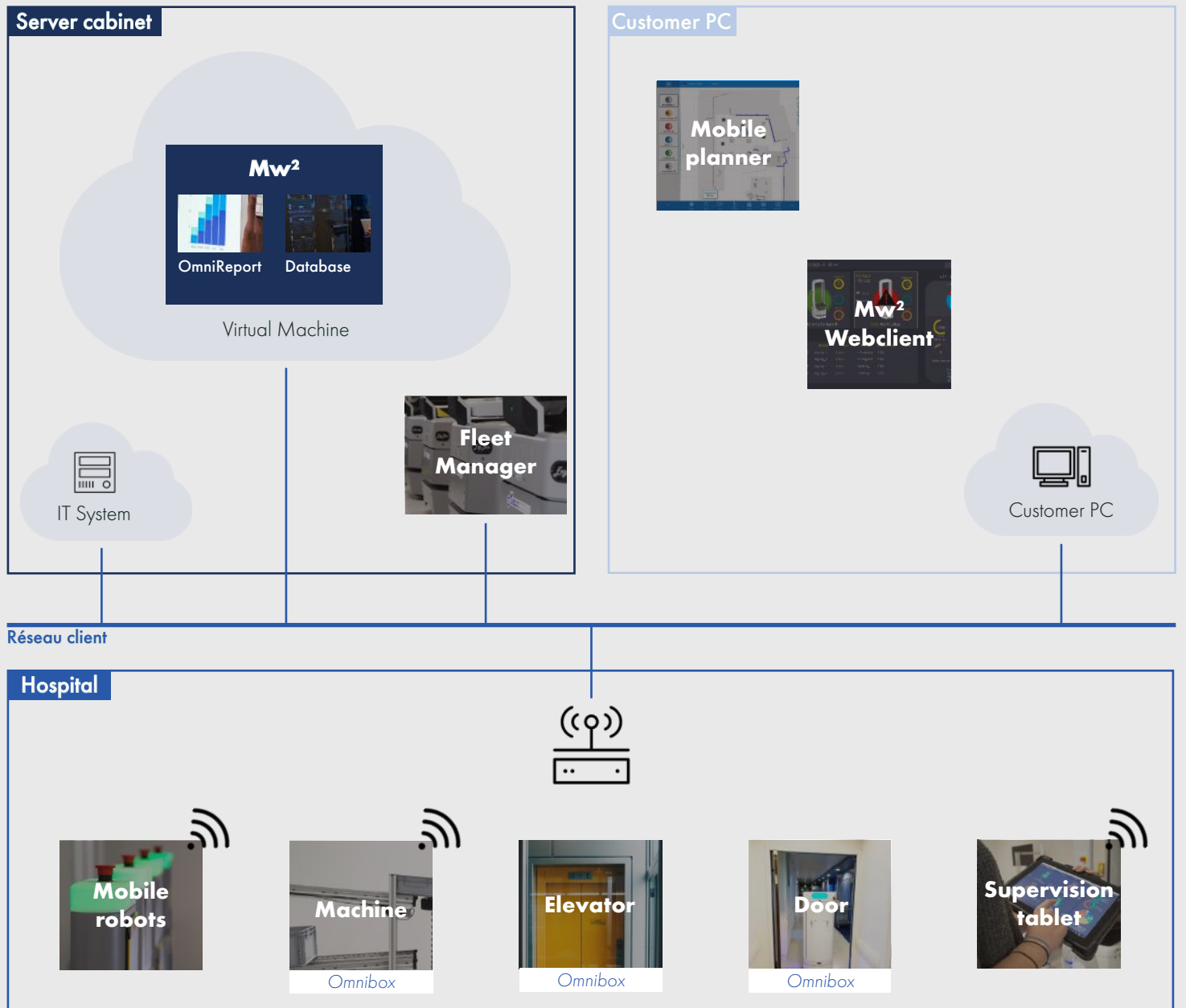

# Technical specifications



## General

Max. speed

Dimension (LxWxh)

Mechanical weight

1.80m/s (6,48km/h)

700 x 670 x 1800 mm (700mm diameter)

100 kg



## Application

Technology

Degree disinfection coverage

Volume of air treated/h

Pathogen reduction rate at each passage through the reactor

Air purification using UV-C light

360°

138 m<sup>3</sup>

32 - 99 %

(A continuous disinfection will ensure an important number of passages and hence guarantee a reduction rate close to 99%)

UV-C lamps lifetime

9 000 hours



## Mobility

Navigation

Environmental map making method

Move

Autonomous routing by localizing with safety scanning laser based on environment mapping.

Scan by walking the mobile robot through the environment.

Avoidance and by passing of obstacles by calculating a new trajectory.



## Human-Machine interface

Touchscreen

Manual Mode

7" TFT LCD screen, 800x480 pixels

Two push buttons to move the robot manually if necessary



## Environnement

Operating temperature range

IP Class

Application environment

Climb grade

Floor requirement

5 - 40° C

IP20

Indoor use only, limited dust and oil suspension

Max : 8%

Linoleum, epoxy or concrete (no water, no oil, no dust)



# Technical specifications



## Safety

*Safety scanning laser*

At front, Class 1  
PLd safety per ISO 13841-1  
15m maximum range  
240° field of view

*Low front laser*

1 at front, Class 1  
4m maximum range  
126° field of view

*Side lasers*

1 on each side of the platform, Class 1  
4m maximum range  
270° field of view

*Emergency Stop*

2 on each side of the robot

*Rear Sonar*

2 at rear, 2m range

*Front bumper*

1 at front of platform, 2 pairs of sensors

*Warning lights*

Light discs on each side  
Upper LED strips

*Speaker and buzzer*

3.5", 80W max



## Battery

*Run time*

± 8 hours

*Recharge time*

± 4 hours

*Voltage*

22-30 VDC LiFePO4

*Capacity*

72 Ah nominal capacity

*Battery life time*

2 000 recharge cycles

*Charging method*

Automatic, manual



## Communication

*WI-FI*

IEEE 802.11 a/b/g/n/ac

*Bluetooth*

Bluetooth 2.+ERD



## Declaration

*EC Declaration of conformity*

CE Marking

**MeanWHOLE**